

PUSH SWITCH

SPEA SERIES

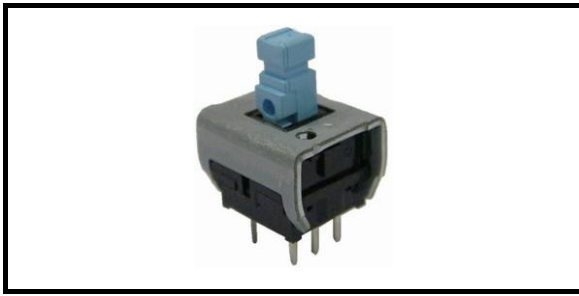

◆ Feature

- 1.2mm travel
- 8.5mm in lever height from P.C.B
- support 2 poles and 4 poles

◆ Applications

- Audio system,TV,Mixer
- consumer electronics products,industrial electronic equipments.

◆ Common specifications

Items	Stand specification
Ratings	0.1A 30V DC
Operating life without load	10,000 cycles
Initial contact resistance	30mΩ max.

◆ Products line

Frame	Poles	Position	Changeover timing	Terminal	Operating force	Operating	Travel (mm)	Total travel (mm)	Products No.	Drawing No.
Without mounting hole	2	2	Non-shorting	Printed	250±100gf	Self lock Non-lock	1.2	1.7	SPEA12MC01	1
	4				300±100gf				SPEA12MC03	2

◆ PUSH SWITCH PRODUCTS NUMBERING SYSTEM

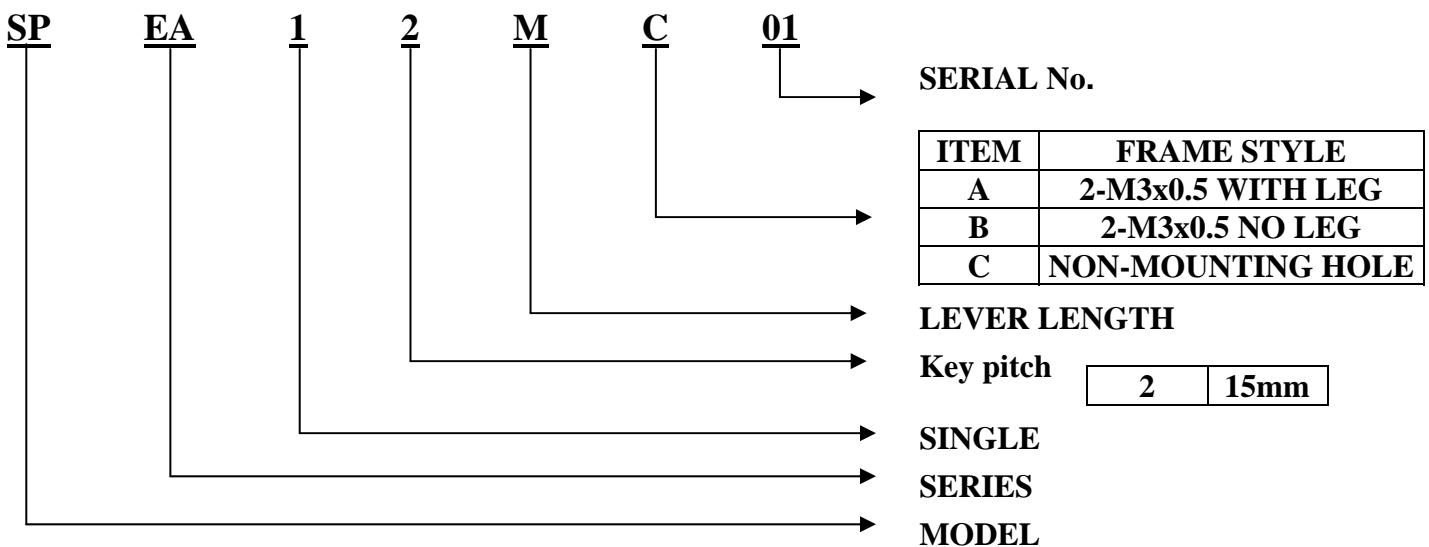

◆ Common specification

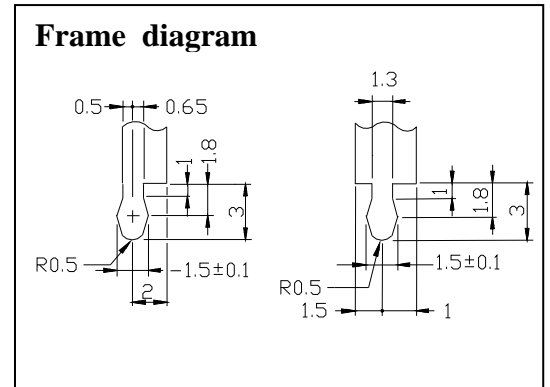
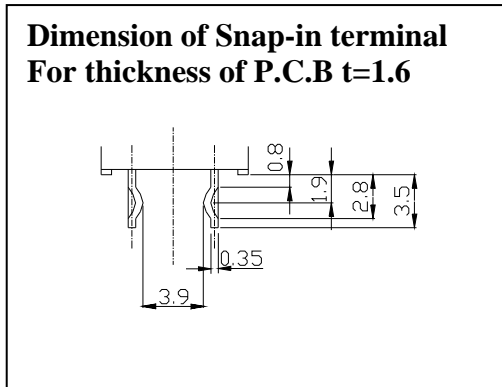
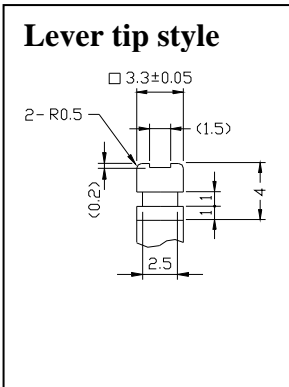

◆ Dimension

Unit : mm

No	Dimensions	Circuit diagram Viewed from the direction A	
		P.C. board mounting hole dimensions (viewed from the direction A)	
1			
2			