

MLP56L 8x8, Packing Drawing

Packing Description:

MLP56L 8x8 products are classified under Moisture Sensitive Level 3 at 260 °C peak package body temperature.

The carrier tape is made from dissipative polystyrene or polycarbonate resin. The cover tape is a multilayer film primarily composed of polyester film, adhesive layer, heat activated sealant, and anti-static sprayed agent. These reeled parts in standard option are shipped with 3000 units per 330 mm diameter reel. The reels are made of polystyrene plastic (anti-static coated or intrinsic).

These full reels are individually barcode labeled and placed inside a pizza box made of recyclable corrugated brown paper with a Fairchild logo printing. The reel is packed single reel in the pizza box. And these pizza boxes are placed inside a barcode labeled shipping box which comes in different sizes depending on the number of parts shipped.

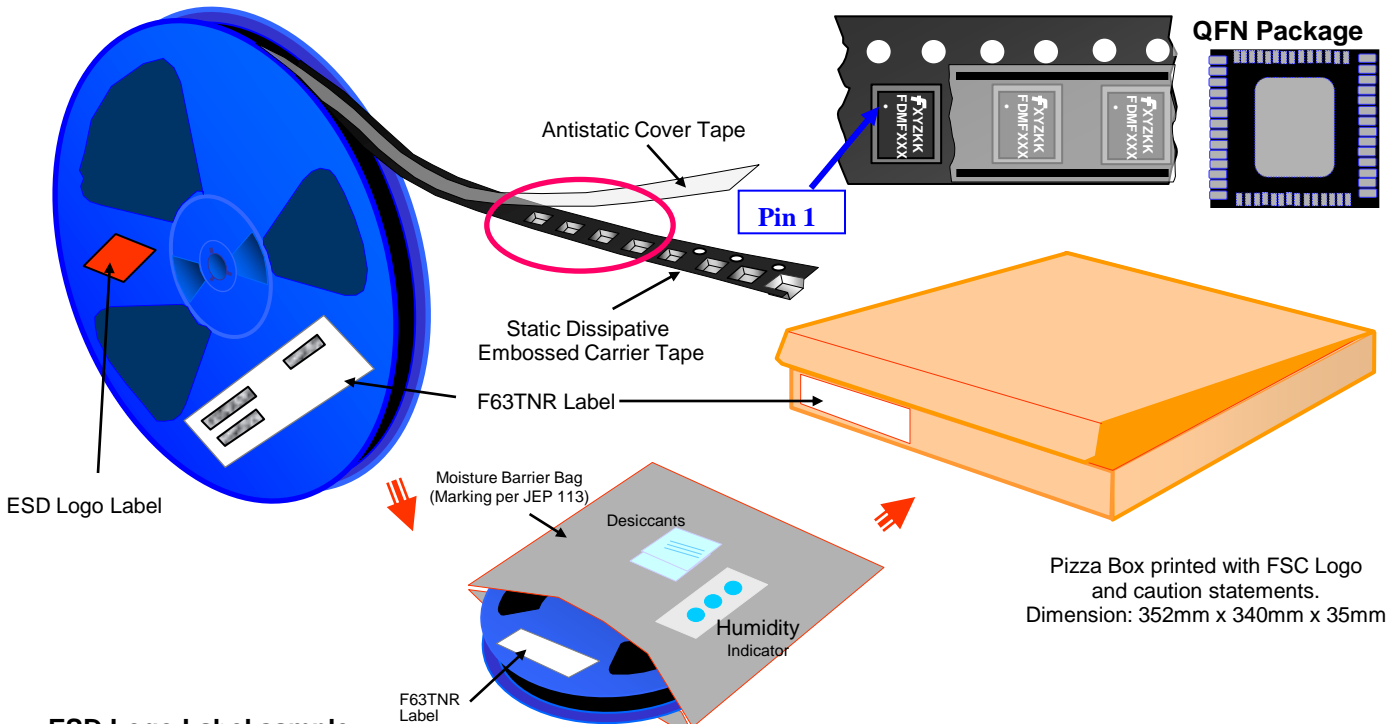

ESD Logo Label sample



F63TNR Label sample

LOT: PMH010088888	QTY: 3000
FSID: FDMF8704	SPEC:
D/C1: P1215NA QTY1:	2 nd Level Interconnect
D/C2: QTY2:	1. Category G4
SPEC REV: Green Component	2. Maximum safe temperature 260 deg C
RoHS COMPLIANT	3. MSL 3
	FAIRCHILD SEMICONDUCTOR (F63TNR)6.0

Tape Leader and Trailer Configuration

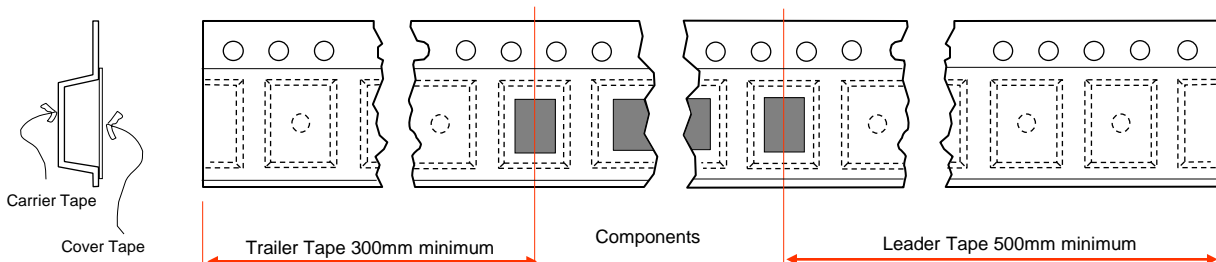

MLP Embossed Tape Dimension

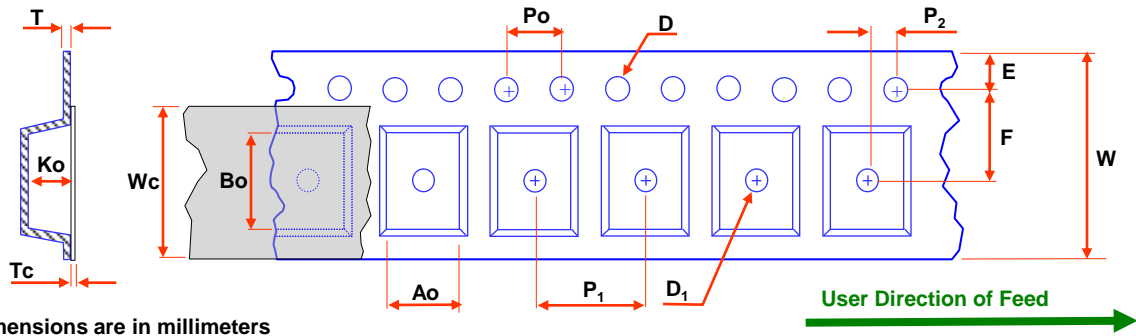

Dimensions are in millimeters

Package	Ao +/-0.10	Bo +/-0.10	D +/-0.05	D ₁ min.	E +/-0.1	F +/-0.1	Ko +/-0.1	P ₁ TYP	Po TYP	P ₂ +/-0/05	T TYP	Tc +/-0.005	W +/-0.3	Wc TYP
MLP56B	8.30	8.30	1.55	1.5	1.75	5.5	1.10	12.0	4.0	2.0	0.3	0.07	16	13.3

Notes: Ao, Bo, and Ko dimensions are determined with respect to the EIA /Jedec RS-481 rotational and lateral movement requirements (see sketches A, B, and C).

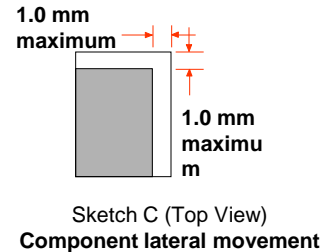
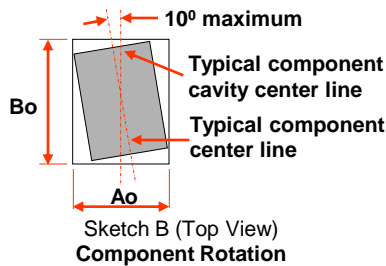
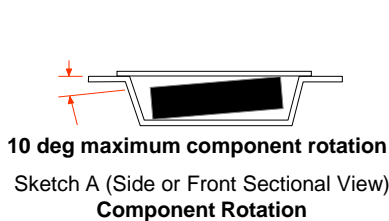

Shipping Reel Dimension

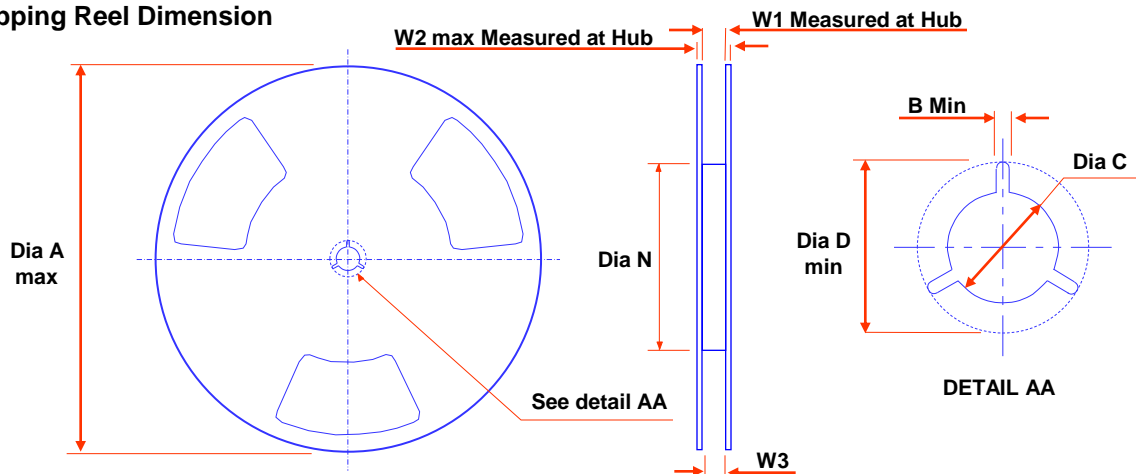

Dimensions are in millimeters

Tape Width	Dia A max	Dim B min	Dia C +.5/- .2	Dia D min	Dim N min	Dim W1 +2/-0	Dim W2 max	Dim W3 (LSL - USL)
16	330	1.5	13	20.2	178	16.4	22.4	15.9~19.4

APPROVALS	DATE	FAIRCHILD SEMICONDUCTOR			
DRAWN		MLP56L 8x8 Packing Configuration			
DFTG. CHK.					
ENGR. CHK.					
PROJECTION	SCALE: 1:1	SIZE: N/A	DRAWING NUMBER: PKG - MLP56B	REV: 1	DO NOT SCALE DRAWING