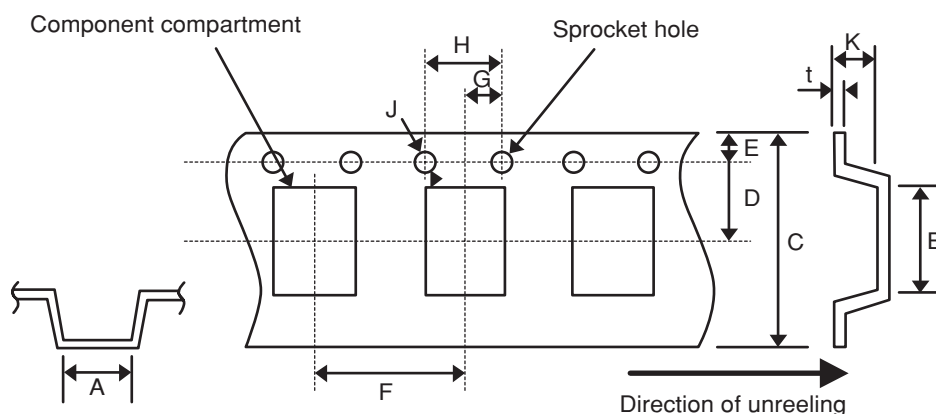
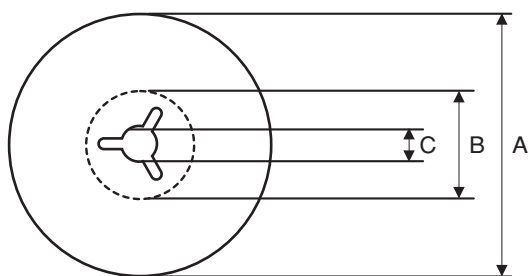

**◆ CARRIER TAPE DIMENSIONS**

(mm)

	A ±0.1	B 0.1	C ±0.3	D ±0.05	E ±0.1	F ±0.1	G ±0.05	H ±0.1	J -0, ±0.1	K ±0.2	t ±0.05
SM/SLE/SZE	4.50	7.60	12.0	5.5	1.75	8.0	2.0	4.0	φ 1.5	1.6	0.3
SXB/SXE/SWZ										2.2	
SW(2.7mm)										2.9	
SW(2.9mm)										3.1	
NSX	3.70	6.40	12.0	5.5	1.75	8.0	2.0	4.0	φ 1.5	2.1	0.3

- ◆ Dimension A and B are the measure of compartment's inside bottom.
- ◆ The (+) polarity of the chip is placed on right side towards the unreeling direction.
- ◆ Dimension of top cover tape (Thicknees of cover tape :  $75 \pm 25 \mu\text{m}$ , Width of cover tape :  $9.5 \pm 0.2 \text{mm}$ )

**◆ REEL DIMENSIONS**

Packing quantity

Series	Pieces/Reel
SM/SLE/SZE	3500
SXB/SXE/SWZ/NSX	3500
SW	2000

EIAJ ET-7200B

(mm)

A	B	C	W1	W2
$\phi 330 \pm 2.0$	$\phi 80 \pm 1.0$	$\phi 13 \pm 0.2$	13.4 1.0	$17.4 \pm 1.0$

**◆ MARKING**

**PC-CON**

**337** ← \*1 Rated Capacitance

**d 84** ← Lot No.\*2

← Rated Voltage\*3

Anode

\*1 2 and 3 columns are indicative significant figures. 1 column show the number of the zero following significant figures by pF. (multipliers of ten)

\*2 Lot No. shows roughly manufacturing date, Jan to Sep. are 1 to 9, Oct. is O, Nov. is N, and Dec. is D.

\*3 Rated voltage mark

Mark	Rated voltage
d	2 V.DC
e	2.5 V.DC
g	4 V.DC
j	6.3 V.DC
k	8 V.DC

**◆ PART NUMBER**

□□□ Rated Voltage	□□□ Series	□□□ Rated Capacitance	□ Capacitance Tolerance
↓	↓	↓	↓

Code	Rated Voltage
2	2 V.DC
2.5	2.5 V.DC
4	4 V.DC
6	6.3 V.DC
8	8 V.DC

Code	Series
SM	SM series
SLE	SLE series
SXB	SXB series
SXE	SXE series
SW	SW series
SZE	SZE series
SWZ	SWZ series
NSX	NSX series

Code	Capacitance
10	10
15	15
22	22
33	33
47	47
68	68
82	82
100	100
120	120
150	150
180	180
220	220
270	270
330	330
390	390
470	470

Code	Tolerance
M	± 20%

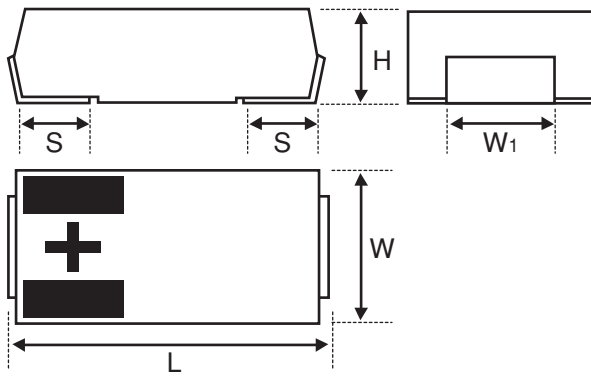
**◆ DIMENSIONS**

(mm)

Series	L (±0.2)	W (±0.2)	H (±0.2)	S (±0.2)	W1 (±0.1)
SM/SLE/SZE	7.3	4.3	1.4	1.3	2.4
SXB/SXE/SWZ	7.3	4.3	1.9	1.3	2.4
SW	7.3	4.3	2.7	1.3	2.4
SW	7.3	4.3	2.9	1.3	2.4
NSX	6.0	3.2	1.9	1.2	1.8

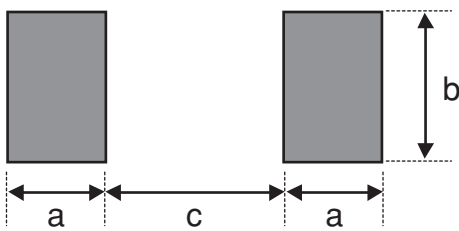
**◆ RECOMMENDED LAND PATTERN DIMENSIONS**

(mm)

シリーズ名 Series	a	b	c
SM/SLE/SZE	2.4	2.9	3.7
SXB/SXE/SWZ			
SW			
NSX	2.4	2.3	2.4

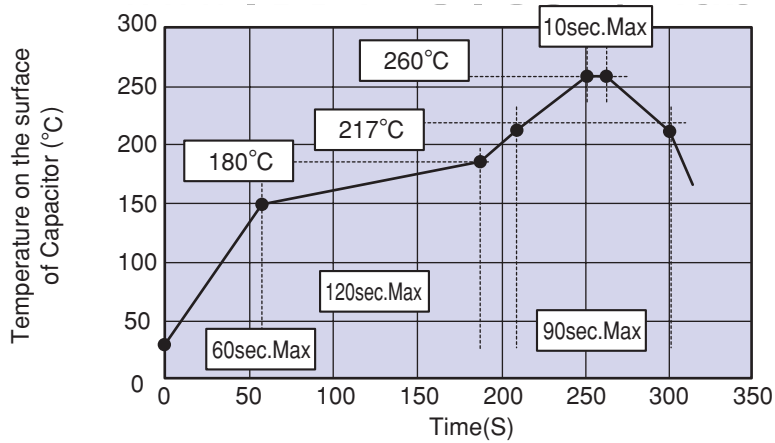
**◆ RECOMMENDED REFLOW SOLDERING CONDITION**

Please do not perform reflow soldering more than 2 times.